



Rugged and reliable hour meters in rectangular or round case, for AC or DC operation



Ruggedness and reliability are featured in the Series 7795 electric hour meters. One-tenth hour resolution, round or rectangular package and cutout styles and a choice of DC or AC inputs allow its use on construction machinery or leased equipment to determine usage, maintenance, and warranty periods.

- Easy to install
- Compact and requires only a small panel cutout
- Durable and shock resistant
- Lightweight for use on portable equipment
- Sealed against dirt and moisture
- Tamper-proof and non-resettable
- Easy to read figures

SPECIFICATIONS

Panel Mounting:

Round Case: 2.00" diameter cutout
 Rectangular Case: 0.95" x 1.45" cutout

DC Hour Meters:

Input: 10 to 32 VDC
 Accuracy: 0.02%
 Capacity: Up to 9999.9 hours, automatic recycle at zero
 Operating Temperature: -40° to +185 °F (-40° to +85 °C)

AC Hour Meters:

Input: 120 VAC (range ± 10%), 60 Hz
 Accuracy: 1%
 Capacity: Up to 9999.9 hours, automatic recycle at zero
 Operating Temperature: -65° to +154 °F (-18° to +68°C)

Model No.	Description
779555-216	Round Case, 10 to 32 VDC, Spade Terminals
779565-216	Rectangular Case, 10 to 32 VDC, Spade Terminals
779516-201	Round Case, 120 VAC, Screw Terminals
779526-201	Round Case, 120 VAC, 7" Leads
779536-201	Rectangular Case, 120 VAC, Screw Terminals
779546-201	Rectangular Case, 120 VAC, 7" Leads

Dimensions:

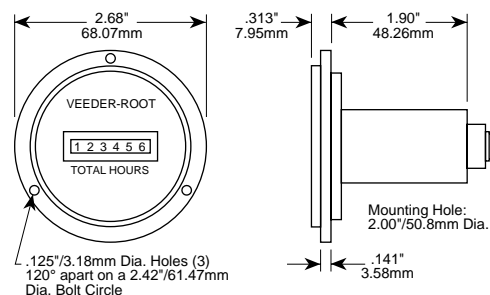
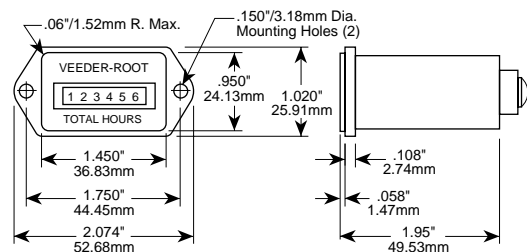

Typical Applications:

